



52 ANGEL STREET

Hadleigh | Suffolk



Chapman Stickels

52 ANGEL STREET, HADLEIGH, SUFFOLK, IP7 5EY

A 2-BEDROOM VICTORIAN COTTAGE CONVENIENTLY LOCATED CLOSE TO
THE TOWN CENTRE

Colchester – 13 miles

Manningtree – 9 miles

Ipswich – 9 miles

-
- Entrance porch ● Sitting room ● Dining room ● Kitchen ● Downstairs bathroom ●
 - 2 double bedrooms ● Rear garden ●





The Property

52 Angel Street is a mid-terrace cottage located close to the centre of the market town of Hadleigh. Set back from the road in a row of just 4 other houses, the property is well placed for all the towns' amenities.

Accessed via a small porch to the front, the accommodation is deceptively spacious and well laid out; despite requiring some cosmetic updating. A cosy sitting room leads through to the dining room with inset storage space, and the kitchen beyond which is fitted with a range of cupboards and worksurfaces with space for white goods below. To the rear of the house is the bathroom fitted with a washbasin, WC, shower over bath, and frosted windows to the outside.



Upstairs are two good sized double bedrooms, both with large windows affording plenty of natural light for a bright and airy feel.

Outside, the property has a small rear cottage garden which is mainly laid to lawn. To the front of 52 Angel Street is a partly walled area with space for bin storage.



Agents Note

This property is suitable for investment only. There is a tenant in situ on an Assured Shorthold Tenancy expiring mid-June 2023.

EPC Rating

Current D(61), Potential B(81).

Services

All mains services are connected.

Local Authority and Council Tax

Babergh with Mid Suffolk District Council.
Band B.

52 Angel Street, Hadleigh, IP7 5EY

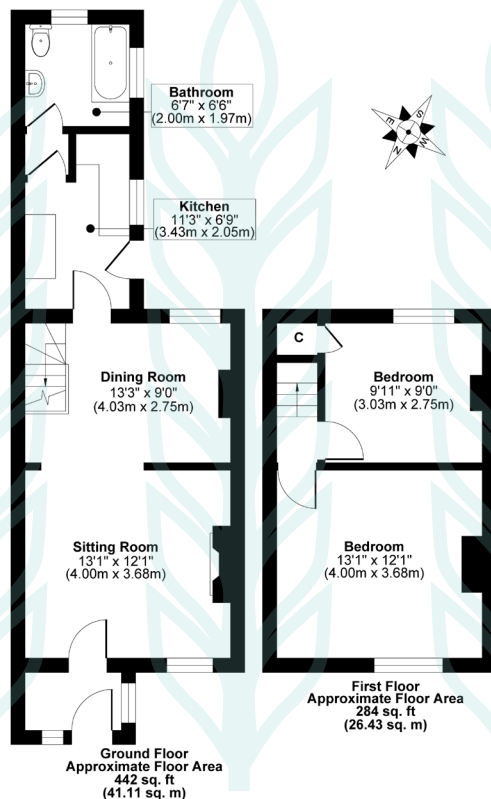

Chapman Stickels

The Corn Exchange,
Market Place,
Hadleigh,
Suffolk,
IP7 5DN

info@chapmanstickels.co.uk
www.chapmanstickels.co.uk

01473 372 372

All enquiries:

Benedict Stickels

ben@chapmanstickels.co.uk

Robert Chapman

robert@chapmanstickels.co.uk



Scan the QR code to visit our website



rightmove

PrimeLocation.com

onTheMarket.com

Zoopla



IMPORTANT NOTICE
Chapman Stickels states these particulars are for general information only and do not constitute an offer or contract or part thereof. All descriptions, photographs and plans are for guidance only and should not be relied upon as statements or representations of fact. All measurements are approximate where stated. Any prospective purchaser must satisfy themselves of the accuracy of the information within these particulars by inspection or otherwise. Chapman Stickels does not have any authority to give any representations or warranties whatsoever in relation to this property (including but not limited to planning/building restrictions), nor can it enter into any contract on behalf of the client. We do not accept responsibility for any expenses incurred by prospective purchasers in inspecting properties which have been sold, let or withdrawn. If there is anything of particular importance to you, please contact us where we will endeavour to have any information or queries checked.